

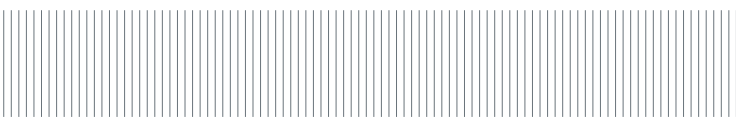

# Optima 97

Workspace redefined

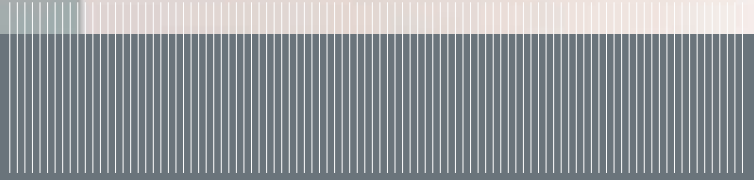



**Optima 97** is recognised as the most advanced drywall system available on the market today. If you need a solid drywall system that guarantees the highest precision and quality, then there is no better solution than Optima 97.

Our unique tapeable aluminium sections, used in conjunction with tapered joggled studs, ensure you a perfectly true, distortion free solid wall, unachievable with traditional drywall systems. Optima 97 is also eminently flexible, allowing you to choose either single or double board within a 97mm overall thickness to suit your acoustic or performance specification.

You can also use Optima 97 in conjunction with Optima 117, Optima 217 and Revolution glazing systems giving you a stunning seamless interface between glass and drywall.



Acoustic integrity and performance was absolutely critical to this major city legal practice. The combination of flush timber doorsets, single glazing with acoustic glass and drywall achieved this, whilst demonstrating the sharp detailing between glass and drywall using our tapeable glazing bar.

## Optima 97

Workspace redefined

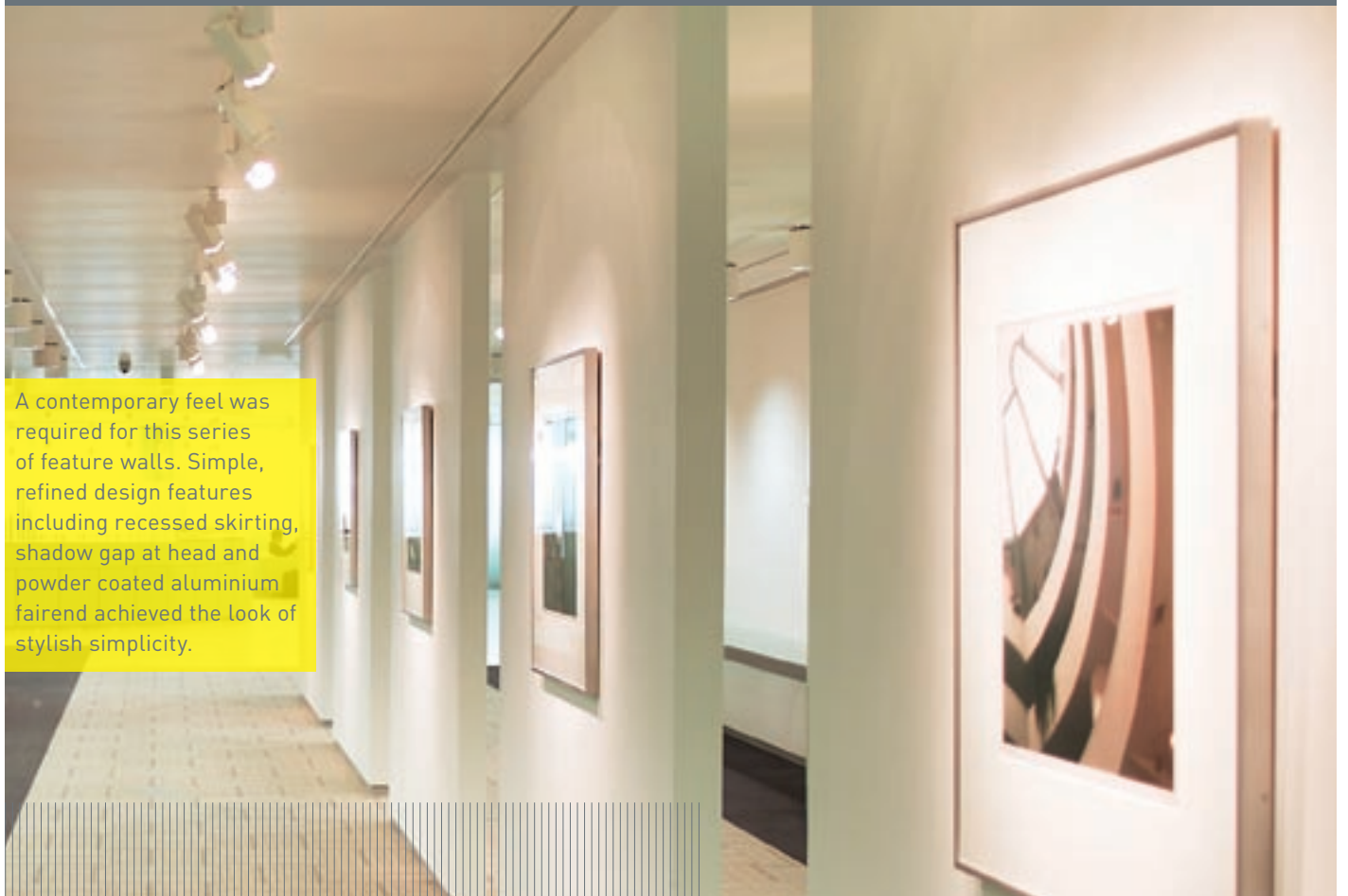
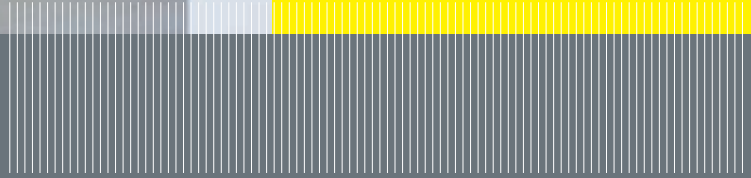

A contemporary feel was required for this series of feature walls. Simple, refined design features including recessed skirting, shadow gap at head and powder coated aluminium fairend achieved the look of stylish simplicity.

This prestigious project within the world famous "Gherkin" demanded a high degree of light penetration. Our drywall and clerestory glazing was an ideal solution. We also utilised our unique tapeable glazing bar both horizontally and vertically ensuring a seamless junction between the glass and solid elements of the structure.



This particular project included bulkheads and alcoves which always demand a high degree of attention to detail. Our in-built deflection head was used to maximum effect here.



# Optima 97

Workspace redefined

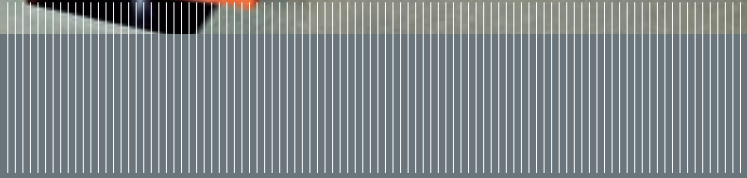

A quick and easy solution was needed to present some amazing memorabilia at this football academy. Our joggled studs eliminated any flaring at the head and our tapeable sections resulted in a perfectly true wall and minimal snagging on site.



# Optima 97 Data

Construction	Max Height
70mm joggled studs at 600mm centres with a single skin of 12.5mm wallboard	4.550m
70mm joggled studs screw fixed back to back at 600mm centres with a single skin of 12.5mm wallboard	5.100m
45mm joggled studs at 600mm centres with a double skin of 12.5mm wallboard	3.830m
45mm joggled studs screw fixed back to back at 600mm centres with a double skin of 12.5mm wallboard	4.700m
70mm joggled studs screw fixed at 600mm centres with a single skin of 12.5mm fire resistant wallboard. Top Channel Shadow head filled with fire block	4.550m

### Joggled Studs

Width is locally reduced [joggled] at head to allow outer layers of board to be pinched in. This allows the partition to be taped and filled but without the flaring at the head often associated with proprietary drywall.

Studs are cold rolled from 0.6mm gauge galvanised steel.  
45mm stud specified if double boarded.  
70mm stud specified if single boarded.

### Skirtings

Options: flush (MDF or aluminium), recessed or surface fixed available in various finishes.

### Aluminium Sections

All exposed sections powder coated to any RAL colour in accordance with BS6496: 1984.

### Glazing

Optima 97 is fully compatible with all of our glazing systems. Aluminium tapeable glazing bars are available for 117 single glazing, 217 double glazing and Revolution 69 where a seamless interface between glass and drywall is required. They can be used vertically where a glass fin abuts the drywall, or horizontally with partial height drywall and clerestory glazing.

#### 117

Single glazed tapeable glazing bar can accommodate glass up to 16.8mm thick.

#### 217

Double glazed tapeable glazing bar can accommodate glass up to 6.4mm + 10.8mm thick.

### Revolution

Double glazed tapeable glazing bar can accommodate glass up to 12.8mm + 12.8mm thick.

### Deflection

Optima 97 can incorporate a unique extruded aluminium deflection head to accommodate up to +/-25mm. +/-40mm deflection head can be achieved subject to special order. Please consult our Technical Team.

### Acoustics

1 layer of 12.5mm wallboard with 100 x 65 x 600mm long mineral wool fibre blocks of 60kg/m<sup>3</sup> density fitted into underside of head, plus 50mm mineral insulation blocks of 60kg/m<sup>3</sup> density to remaining cavity = Rw43dB

2 layers of 12.5mm wallboard either side of stud with insulation at head and within cavity = Rw48dB

Optima 97 can also accommodate 12.5mm Soundbloc board for an enhanced acoustic performance.

### Fire Protection

Fire tested to BS476: Part22: 1987  
Report No. TE 83026  
30 minute fire rating.

# Optima 97 Data

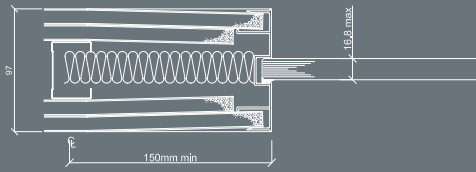

Single glazed tapeable glazing bar

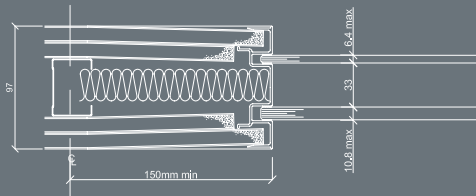

Double glazed tapeable glazing bar

Two-part deflection head, flush aluminium skirting

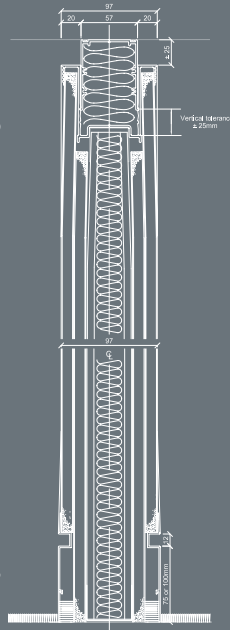

Celing abutment with shadow gap, flush MDF skirting

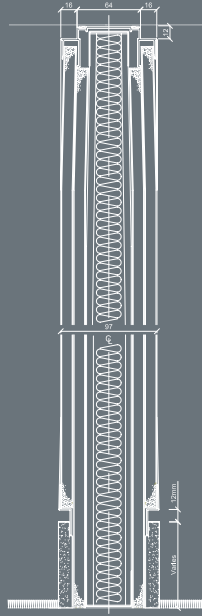

Flush ceiling abutment, applied skirting

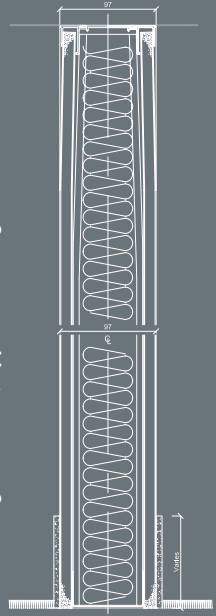

# Optima 97

Workspace redefined

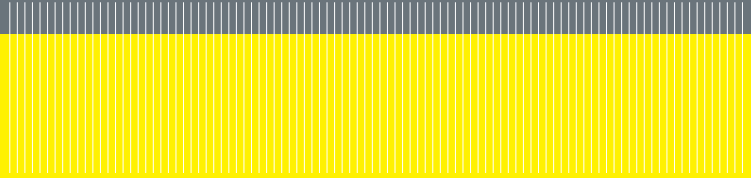

This close-up shot clearly demonstrates the precision and quality of Optima drywall, used here with fully recessed skirting and aluminium tapeable glazing bar at the junction of the glass and solid elements.

Courtyard House West End Road High Wycombe Bucks HP11 2QB t +44 (0) 1494 492 725



# Optima 97

Workspace redefined